

1.1. How to setup serial number in USB printer.

- Execute the setup utility and click the “Setup USB” button as below.

The screenshot shows the 'Label Printer Configuration Utility 1.50' window. The 'Port' dropdown is set to 'Wi-Fi'. The 'USB Connection' section contains 'Read from printer...' and 'Save to printer...' buttons. The 'Search Results (Wi-Fi)' section is empty. The 'Setup Ethernet' button is visible. The 'Setup USB (Serial Number)' button is highlighted with a red rectangle. The 'Download Firmware' button is also visible. The 'Download Function' section includes 'Open...', 'Application Download...', and 'File Download...' buttons. The 'WPA' section includes 'WPA Authentication', 'WPA Encryption Key', and a note 'WPA Key is characters of 8 ~ 63 length'. The 'Exit' button is at the bottom right.

Port : Wi-Fi

SSID :
IP :
Netmask :
Gateway :
DNS :

Wi-Fi Mode :
Wi-Fi Channel :
Wi-Fi Encryption :
Wi-Fi Authentication :
Using KEY ID :

KEY ID 1 :
KEY ID 2 :
KEY ID 3 :
KEY ID 4 :

☐ DHCP Settings
TCP Port :

WPA
WPA Authentication :
WPA Encryption Key :
WPA Key is characters of 8 ~ 63 length

Download Function
Open...
File Name :
Application Download...
File Download...

Search...
Save...

Exit

- Connect one USB printer to Desktop and turn on the printer.
 - Click the “Search the connected printer” button and check the connection.
- The serial number of the printer is sw07000002 as below.
- If the serial number is not set, display the “?”.

SEWOO TECH USB Serial number setup 1.00

Connected printer information

 **Search the connected printer** USB001

Serial number of connected printer :

Change the serial number of connected printer

Serial number to change : sw0700000 2

 **Change the serial number of printer**

 **Exit**

- Change the serial number of printer as below and click the “Change the serial number of printer” button.

At that case, the serial number of printer is changed sw07000001.



- When a dialog displayed as below, click the “OK” button and reset the printer.

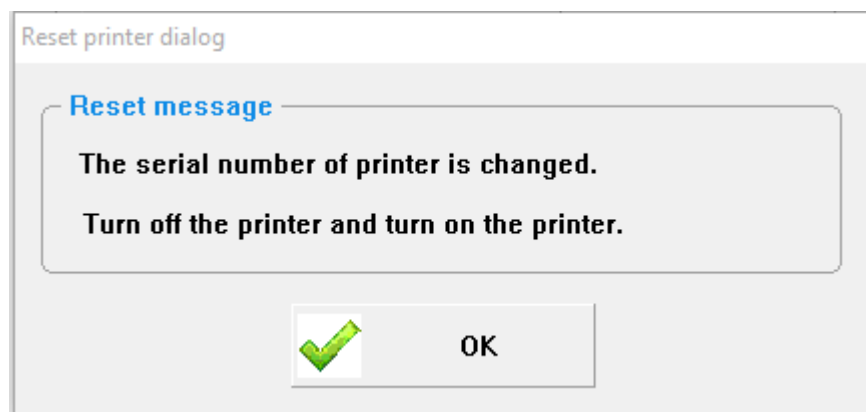

- After connecting a USB printer recognition is completed, click the “Search the connected printer” button on the connected USB printer to the USB serial number to verify that normally change as sw07000001

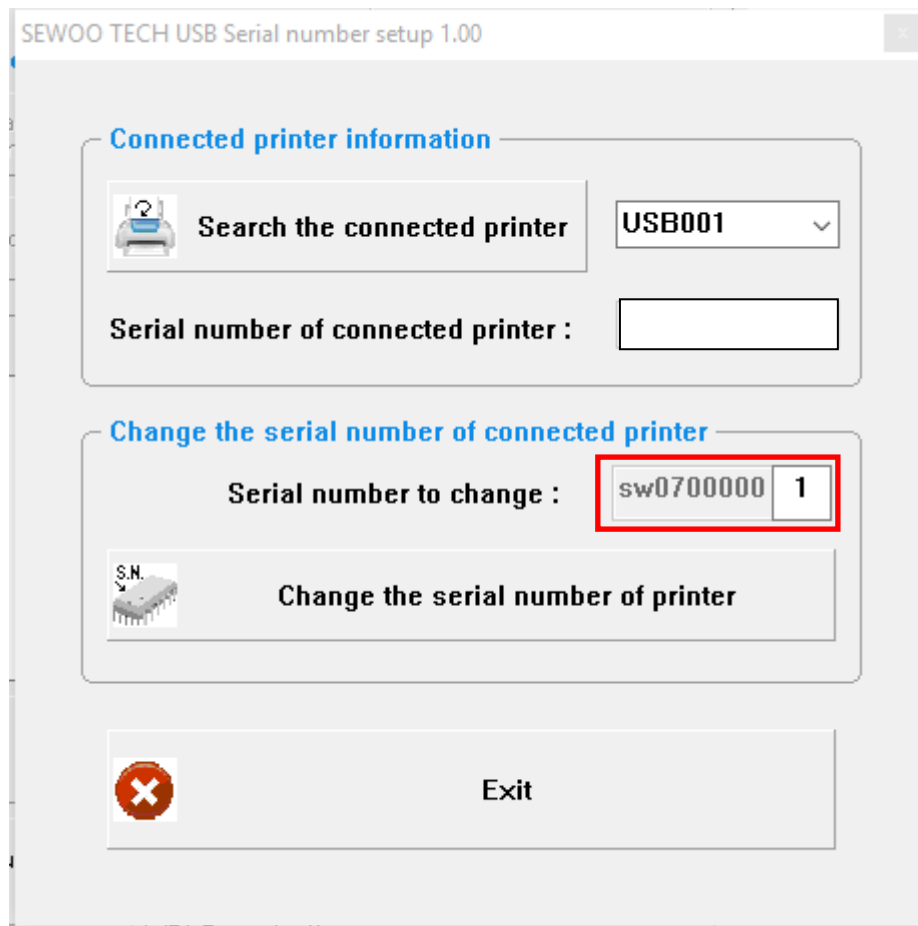

When using a USB printer to the above features it must be set by connecting one printer.

For example, when applying the serial number of the printer and the printer-A and printer-B

First, you connect to the printer only printer-A PC (Desktop), set the serial number.

After that, turn off the printer printer-A, then connect the printer printer-B, set the serial number.